



KYO-CAT

Taper Adapters



■ Available in CAT40 & CAT50 Sizes

■ Endmill and Facemill Styles Available

CAT40

Face Mill Toolholders

- Made from 8620 Alloy Steel
- Concentricity is less than .0002 at face and arbor
- All critical surfaces are precision ground
- Case hardened to 54-58 RC
- Case depth is .03-.04
- Balanced to G2.5 @ 20,000 rpm
- Rear thread for pull stud is 5/8-11
- Coolant through capable

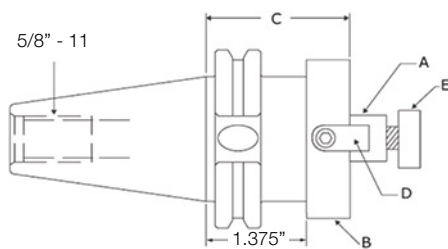

Fig.1

CAT40

Endmill Toolholders

- Made from 8620 Alloy Steel
- All critical surfaces are precision ground
- Case hardened to 56-58 RC
- Case depth is .03-.04
- Balanced to G2.5 @ 20,000 rpm
- Concentricity is .0001 or less
- Rear thread for pull stud is 5/8-11
- Coolant through capable

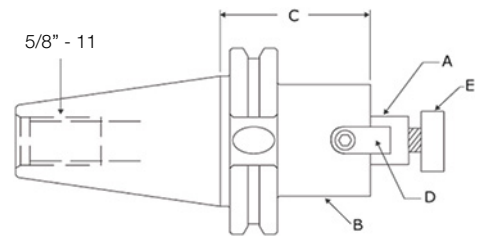

Fig.2

CAT40 Face Mill Holder

Part Number	Stock	Dimensions (in)					Fig.	Suggested Retail Price
		Arbor Diameter (A)	O.D. (B)	Gage Length (C)	Key Width (D)	Screw (E)		
KYO-CAT40- FM.75-2.0	●	0.750	1.750	2.000	5/16	3/8-24	2	\$139
FM1.0-2.0	●	1.000	2.180	2.000	3/8	1/2-20	1	\$139
FM1.25-2.0	●	1.250	2.440	2.000	1/2	5/8-18	1	\$139
FM1.5-2.0	●	1.500	2.520	2.000	5/8	3/4-16	1	\$139

● : Standard Stock

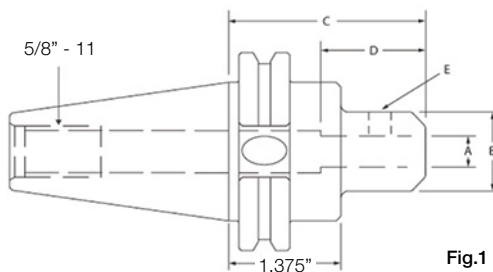

Fig.1

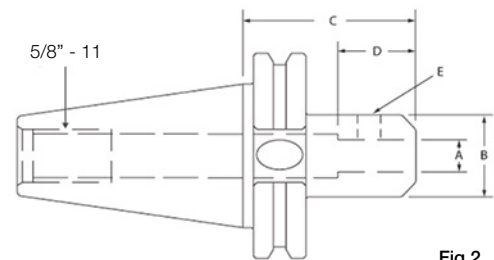

Fig.2

CAT40 Endmill Holder

Part Number	Stock	Dimensions (in)					Fig.	Suggested Retail Price
		I.D. (A)	O.D. (B)	Gage Length (C)	Tool Depth (D)	Set Screw (E)		
KYO-CAT40- EM.500-1.75	●	0.500	1.375	1.750	N/A	7/16-20	2	\$109
EM.625-1.75	●	0.625	1.500	1.750	2.100	9/16-18	2	\$109
EM.75-1.75	●	0.750	1.750	1.750	2.500	5/8-18	2	\$109
EM1.0-1.75	●	1.000	1.750	1.750	2.600	5/8-18	2	\$109
EM1.25-2.5	●	1.250	2.500	2.500	2.750	3/4-16	1	\$114
EM1.5-4.0	●	1.500	2.620	4.000	3.000	2x - 3/4-16	2*	\$129

※ This tool holder does not have a safety zone for the tool changer.
Although most machines do not require a safety zone, please be sure to check your machine tool requirements.

● : Standard Stock

CAT50

Face Mill Toolholders

- Made from 8620 Alloy Steel
- Concentricity is less than .0002 at face and arbor
- All critical surfaces are precision ground
- Case hardened to 54-58 RC
- Case depth is .03-.04
- Balanced to G2.5 @ 20,000 rpm
- Rear thread for pull stud is 1" x 8
- Coolant through capable

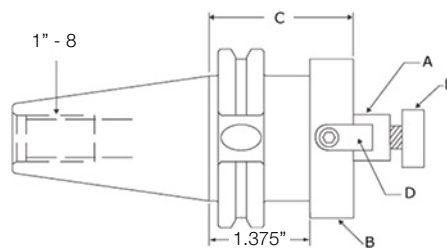

Fig.1

CAT50

Endmill Toolholders

- Made from 8620 Alloy Steel
- All critical surfaces are precision ground
- Case hardened to 56-58 RC
- Case depth is .03-.04
- Balanced to G2.5 @ 20,000 rpm
- Concentricity is .0002 or less
- Rear thread for pull stud is 1" x 8
- Coolant through capable

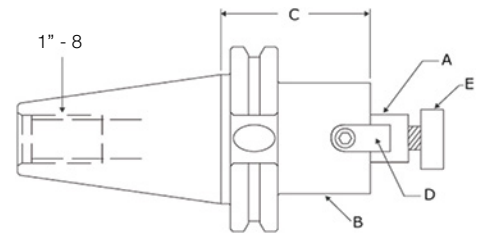

Fig.2

CAT50 Face Mill Holder

Part Number	Stock	Dimensions (in)					Fig.	Suggested Retail Price
		Arbor Diameter (A)	O.D. (B)	Gage Length (C)	Key Width (D)	Screw (E)		
KYO-CAT50- FM.75-3.0	●	0.750	1.750	3.000	5/16	3/8-24	2	\$199
FM1.0-3.0	●	1.000	2.180	3.000	3/8	1/2-20	2	\$199
FM1.25-3.0	●	1.250	2.440	3.000	1/2	5/8-18	2	\$199
FM1.5-3.0	●	1.500	2.740	3.000	5/8	3/4-16	2	\$199
FM2.0-3.0	●	2.000	3.700	3.000	3/4	1-14	1	\$229
FM2.5-3.0	●	2.500	4.000	3.000	1.0	1-14	1	\$229

● : Standard Stock

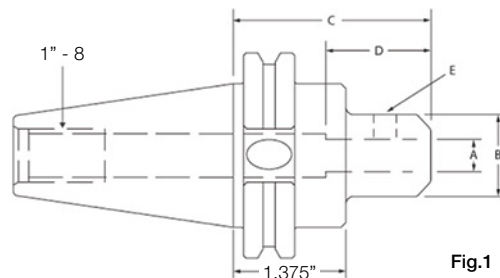

Fig.1

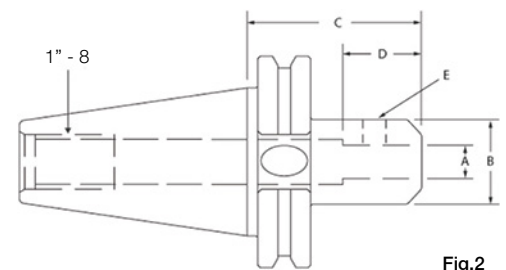

Fig.2

CAT50 Endmill Holder

Part Number	Stock	Dimensions (in)					Fig.	Suggested Retail Price
		I.D. (A)	O.D. (B)	Gage Length (C)	Tool Depth (D)	Set Screw (E)		
KYO-CAT50- EM.500-3.0	●	0.500	1.375	3.000	N/A	7/16-20	1	\$169
EM.625-3.0	●	0.625	1.500	3.000	N/A	9/16-18	1	\$169
EM.75-3.0	●	0.750	1.750	3.000	N/A	5/8-18	1	\$169
EM1.0-4.0	●	1.000	1.900	4.000	2.750	5/8-18	1	\$179
EM1.25-4.0	●	1.250	2.500	4.000	2.750	3/4-16	1	\$179
EM1.5-4.5	●	1.500	2.750	4.500	3.000	2x - 3/4-16	1	\$189
EM2.0-5.0	●	2.000	3.500	5.000	3.500	2x - 1.0-14	2*	\$214

※ This tool holder does not have a safety zone for the tool changer.
Although most machines do not require a safety zone, please be sure to check your machine tool requirements.

● : Standard Stock



KYOCERA
KYO-CAT40-FM1.0-2.0
Made in USA
A01-1063



Kyocera Industrial Ceramics Corp.
Cutting Tool Division

100 Industrial Park Road ■ Hendersonville, NC 28792

Email: cuttingtools@kyocera.com

Website: www.kyocera.com/cuttingtools

Distributor Website: <http://mykicc.kyocera.com>

Customer Service: 800.823.7284 - Option 1

Technical Support: 800.823.7284 - Option 2

©Kyocera Industrial Ceramics Corp.

02/14, 7.5K Printed in U.S.A.

connect with us

